

Axis LED Area Light



USER GUIDE



NOTE:

Please read this entire manual to fully understand and safely use the luminaire.

The products can be used at the voltage of 100-277V AC, 50/60Hz, suitable for indoor and outdoor, moistureproof and dustproof. Specifications are subject to change without notice. Please visit www.axisep.com for the most recent user guide versions.

INCLUDED IN THIS BOX

LED Area Light ,1 PCs

User Guide, 1 Set

UNPACKING

- 1) Unpack and carefully examine the product.
- 2) Report any damage and save all packing materials if any part(s) were damaged during shipping.
- 3) Do not attempt to use this apparatus if it is damaged.

INSTALLATION INSTRUCTIONS

- 1) CONSULT A QUALIFIED ELECTRICIAN TO ENSURE CORRECT BRANCH CIRCUIT CONDUCTOR.
- 2) The product should be installed and operated by a qualified electrician or technician in accordance with relevant local codes.
- 3) Risk of electric shock. Ensure that main power source is off when wiring or soldering the sections of the product.

MAINTENANCE

- 1) Disconnect the product from the power supply prior to cleaning.
- 2) Use a dry or slightly moistened cloth for cleaning.
- 3) Never use any chemicals or abrasive materials for cleaning.

INSTALLATION STEPS

1. Trunnion Mount

Mounting trunnion is available at an extra charge.

- 1) Fix the mounting trunnion to dry wall with screws.
- 2) Fix the fixture to the mounting trunnion with screws.
- 3) Use a screwdriver to loosen the screws and open the fixture.

- 4) Connect the input wires of the fixture to the main power outlet.
- 5) Reattach the fixture front to the back plate. Tighten the housing screws to close the fixture.

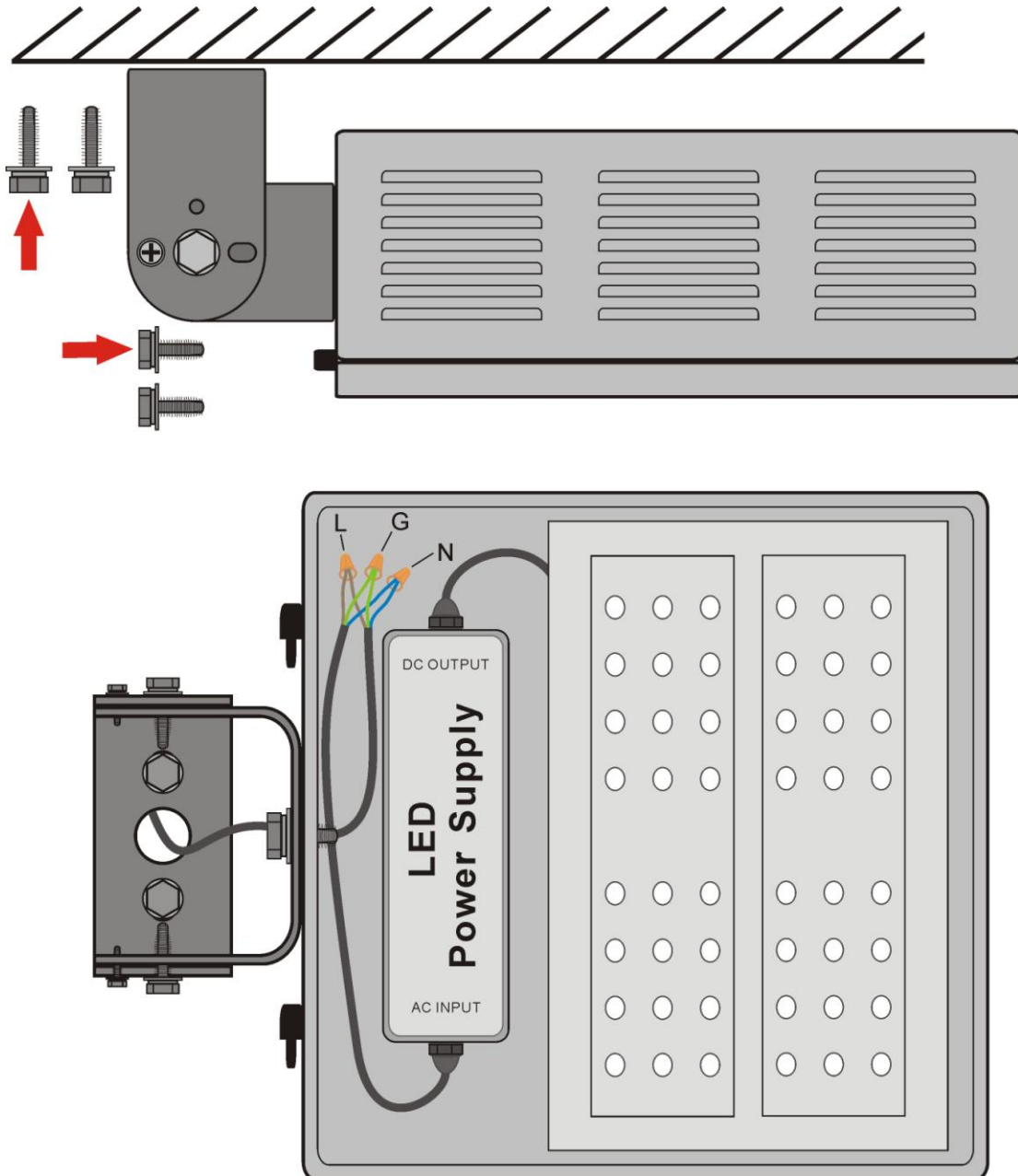

2. Slipfitter Mount

Mounting slipfitter is available at an extra charge.

- 1) Put the mounting slipfitter to the lamp pole.
- 2) Tighten mounting screws.
- 3) Use a screwdriver to loosen the screws and open the fixture.
- 4) Fix the fixture to the mounting slipfitter with screws.
- 5) Connect the input wires of the fixture to the main power outlet.
- 6) Reattach the fixture front to the back plate. Tighten the housing screws to close the fixture.

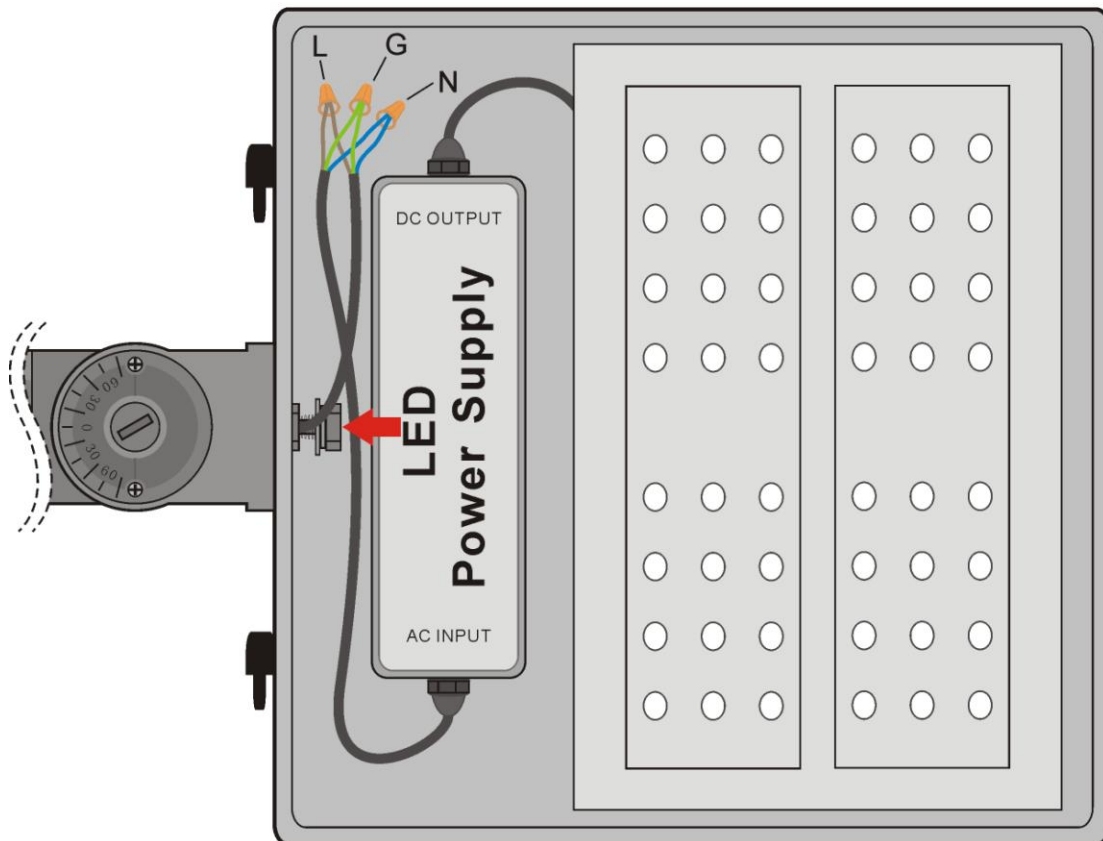
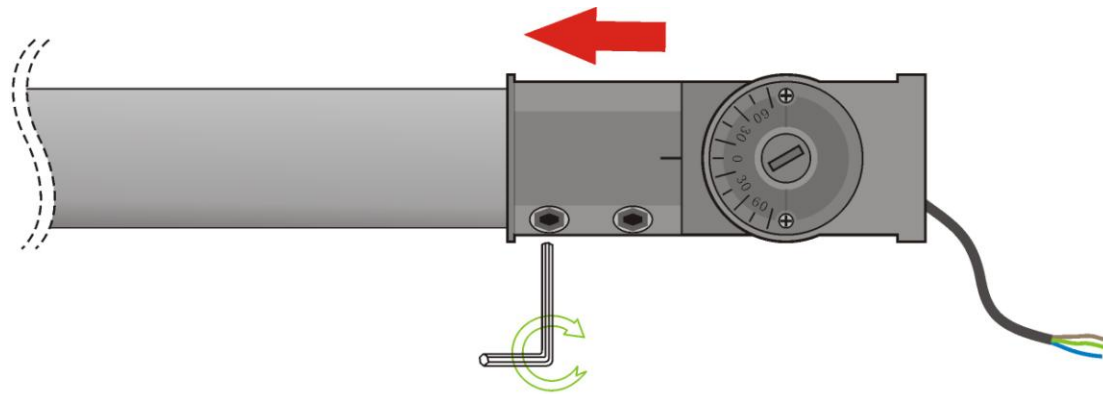

3. Arm Mount

Mounting Arm is available at an extra charge.

- 1) Assemble the fixture, mounting arm and the lamp pole together with screws as shown in the figure below. The wires shall go through the mounting arm.
- 2) Use a screwdriver to loosen the screws and open the fixture.
- 3) Connect the input wires of the fixture to the main power outlet.
- 4) Reattach the fixture front to the back plate. Tighten the housing screws to close the fixture.

